

COPOLYMER POLYPROPYLENE PLASTIC

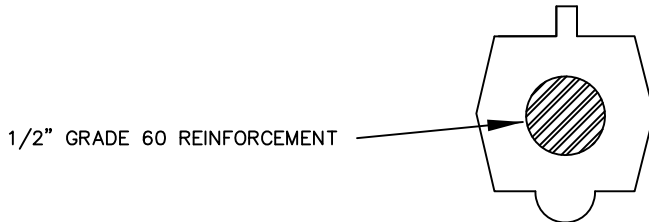

1/2" GRADE 60 REINFORCEMENT

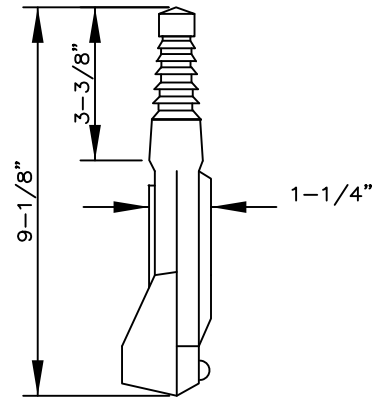
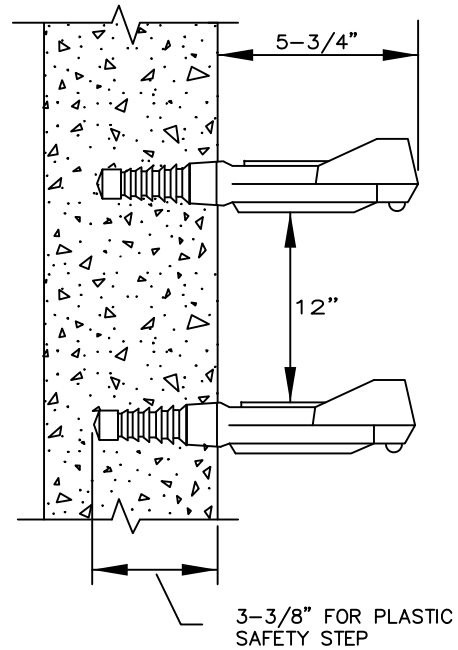

NOTE:
 STEPS IN PREFABRICATED MANHOLE SECTIONS MUST BE TIGHT AND FIRMLY EMBEDDED. THEY MUST ALSO MEET ASTM C-497 TEST FOR WITHSTANDING PULL-OUT.
 TOP STEP SHALL BE NO GREATER THAN 27" FROM TOP OF CASTING.

MATERIALS:

PLASTIC:

MUST CONFORM WITH ASTM C-478. STEEL REINFORCING BAR MINIMUM 1/2" GRADE 60. MEETING REQUIREMENTS OF ASTM A615 ENCAPSULATED WITH INJECTION MOLDED COPOLYMER POLYPROPYLENE WITH SERRATED SURFACES.

Manhole Step

CITY OF
 WILSONVILLE



DRAWING NUMBER: S-2080

DRAWN BY: SR

SCALE: N.T.S.

FILE NAME: S-2080.DWG

APPROVED BY: NK

DATE: 6/4/14

PUBLIC WORKS STANDARDS