

AFFIDAVIT OF POSTING
ORDINANCE CB-0-149-90

STATE OF OREGON)
COUNTIES OF CLACKAMAS)
AND WASHINGTON)
CITY OF WILSONVILLE)

I, the undersigned, City Recorder of the City of Wilsonville, State of Oregon, being first duly sworn on oath depose and say:

On the 28th day of November, 1990, I caused to be posted copies Declaring and Authorizing the Vacation of Public Sanitary Sewer Easements Located Within the Town Center, City of Wilsonville, Clackamas County, Oregon, in the following five public and conspicuous places of the City, to wit:

- WILSONVILLE CITY HALL
- WILSONVILLE POST OFFICE
- LOWRIE'S FOOD MARKET
- KOPPER KITCHEN
- WILSONVILLE PUBLIC LIBRARY

The notice remained posted for more than five (5) consecutive days prior to the time for said public hearing on the 3rd day of December, 1990.

Vera A. Rojas
VERA A. ROJAS, CMC, City Recorder

Subscribed and sworn to before me
this 6th day of December, 1990.

Janella J. Munsterman
NOTARY PUBLIC, STATE OF OREGON

My Commission expires: 9/23/94

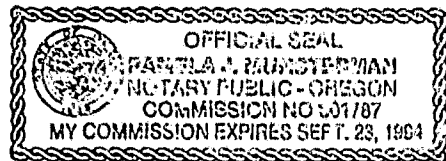

ORDINANCE NO. 378

AN ORDINANCE DECLARING AND AUTHORIZING THE VACATION OF PUBLIC SANITARY SEWER EASEMENTS LOCATED WITHIN THE TOWN CENTER, CITY OF WILSONVILLE, CLACKAMAS COUNTY, OREGON.

WHEREAS, the Capital Realty Corporation has filed with the City a petition setting forth a description of public sanitary sewer easements proposed to be vacated as attached in Exhibits "A" and "B"; and

WHEREAS, the City of Wilsonville has determined that the sanitary sewer lines must be relocated in order to avoid conflicts with the approved building locations in the Wilsonville Town Center Marketplace project; and

WHEREAS, the Wilsonville City Council wishes to address this issue in a timely fashion.

NOW, THEREFORE, THE CITY OF WILSONVILLE ORDAINS AS FOLLOWS:

1. That the portion of public sanitary sewer easement as described in attached Exhibits "A" and "B" shall be vacated.

2. Capital Realty Corporation or its assigns shall provide sanitary sewer easements to replace the easements being vacated prior to occupancy permits being issued for the Town Center Market Place project.

SUBMITTED to the Wilsonville City Council and read for the first time at a regular meeting thereof on the 19th day of November, 1990, and scheduled for a second reading at a regular meeting thereof on the 3rd day of December, 1990, commencing at the hour of 7:30 o'clock p.m., at the Wilsonville City Hall.

VERA A. ROJAS, CMC, City Recorder

ENACTED by the City Council on the 3rd day of December, 1990, by the following votes: YEAS: 3 NAYS: 0.

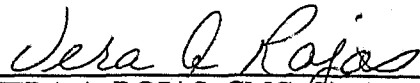
VERA A. ROJAS, CMC, City Recorder

DATED and signed by the Mayor this 4th day of December, 1990.

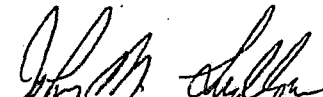
JOHN M. LUDLOW, Mayor

SUMMARY of Votes:

Mayor Ludlow	<u>AYE</u>
Councilor Edwards	<u>ABSENT</u>
Councilor Chandler	<u>AYE</u>
Councilor Clarke	<u>AYE</u>
Councilor Dant	<u>ABSENT</u>



EXHIBIT A

467-01-02
8-09-90

SEWER LINE VACATION

A strip of land being twenty (20') feet and thirty (30') feet in width being situated in the southwest quarter of Section 13, Township 3 South, Range 1 West, W.M., Clackamas County, Oregon. Said strip of land being more particularly described as follows:

That ten (10') foot strip of land described in a sewer line easement granted to Stuart H. Lindquist in Fee Number 78-3509 of Clackamas County, Oregon Records; also, that strip of land being ten (10') and twenty (20') feet in width as described in a sewer line easement granted to Stuart H. Lindquist in Fee Number 78-3510 of Clackamas County, Oregon Records.

Together with that thirty (30') foot strip of land granted to Stuart H. Lindquist in a sewer line easement in Fee Number 78-3508 of Clackamas County, Oregon Records.

ALSO TOGETHER WITH a twenty (20') foot strip of land being a portion of that twenty foot strip of land described in Sewer Line Easements to the City of Wilsonville, Oregon in Fee Number 86-11259 and 86-16354 of Clackamas County, Oregon Records and being more particularly described as follows: COMMENCING at the southwest corner of Section 13, Township 3 South, Range 1 West, W.M., Clackamas County, Oregon; Thence, North 00°03'00" East along the section line common to Sections 13 and 14 a distance of 100.00 feet to the POINT OF BEGINNING; Thence, continuing along said section line North 00°03'00" East a distance of 757.10 feet; Thence, South 89°57'00" East a distance of twenty (20') feet; Thence, South 00°03'00" West and parallel with said section line a distance of 757.10 feet; Thence, North 89°57'00" West a distance of twenty (20') feet to the Point of Beginning.

SOUTHWEST 1/4 SECTION 13, TOWNSHIP 3 SOUTH, RANGE 1 WEST, W.M.
CLACKAMAS COUNTY, OREGON

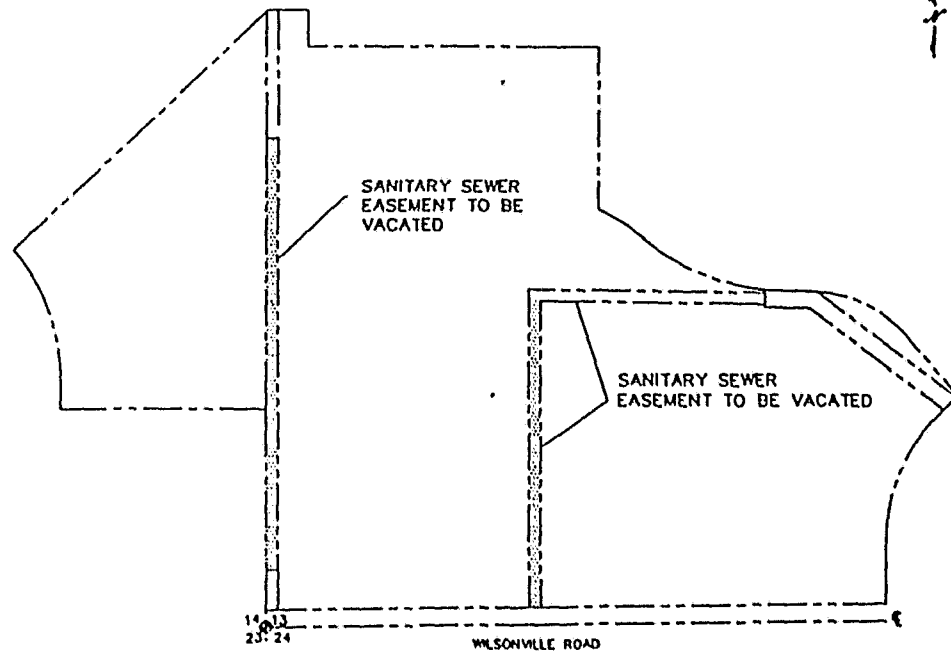

WILSEY & HAM
WHP PACIFIC
PLANNING & ENGINEERING
1000 N. W. 10th St., Suite 100
Portland, Oregon 97227
503.251.1111

EXHIBIT B

DATE	REVISION

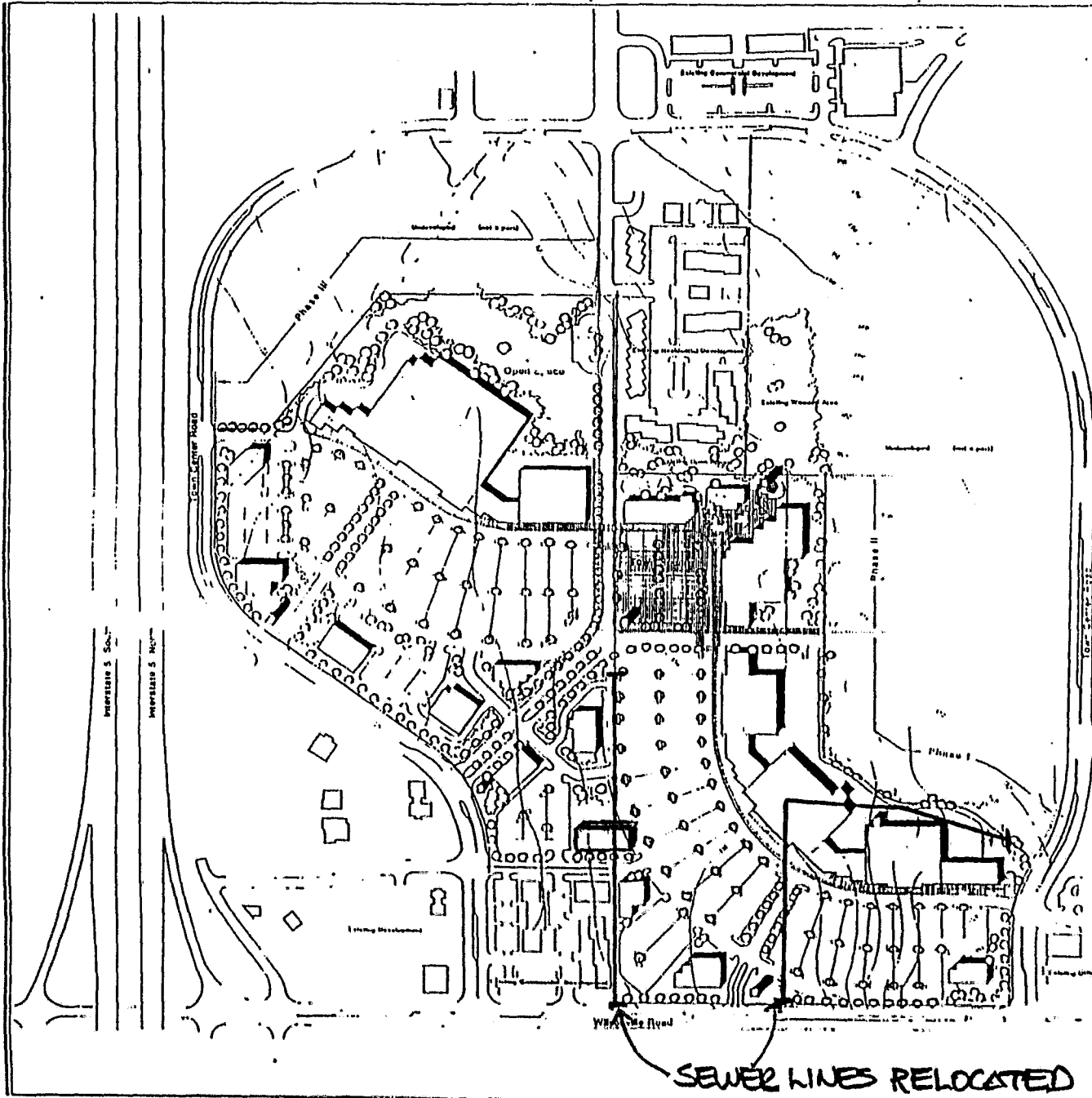

Project Date	
Lot Area	24.06 acres
Phase I	4.52 acres
Phase II	22.79 acres
Total	52.79 acres
Building Area	
Phase I	179,000 sq ft
Phase II	67,000 sq ft
Phase III	179,700 sq ft
Total	625,700 sq ft
Parking	
Phase I	1,011 spaces
Phase II	117 spaces
Phase III	996 spaces
Total	2,094 spaces
Parking Ratio	3 spaces/1000 sq ft
Open Space	5.82 acres



SEWER LINES RELOCATED